



**POLARIS GENERAL 1000 EPS  
WIPER KIT p/n: 1POLGENCVWPR**

The contents of this envelope are the property of the owner.  
Be sure to leave with the owner when installation is complete.



California Proposition 65  
**⚠ WARNING ⚠**  
Engine exhaust, some of its constituents,  
certain vehicle components and fluids,  
contain or emit chemicals known to the  
State of California to cause cancer and birth  
defects or other reproductive harm.

revised: 4-11-2017

## 1. WIPER INSTALLATION

1.1 Per fig. 1.1, mount the wiper motor and the flat cover plate to the inside surface of the windshield. **CAUTION:** The inside surface of the windshield is coated with a plasticized safety film. Use care to avoid scratching the inside surface.

Sandwich the windshield where shown. Orient the bosses on the left-most plastic washers as shown (pointing towards the windshield location/placement). NOTE: if the bosses do not fit into the holes in the windshield, the installation can still be completed as is.

1.2 Remove the switch cover from the dashboard and lead the wiper harness through the opening.

1.3 Connect the wiper switch to the harness and press the switch into the dashboard.

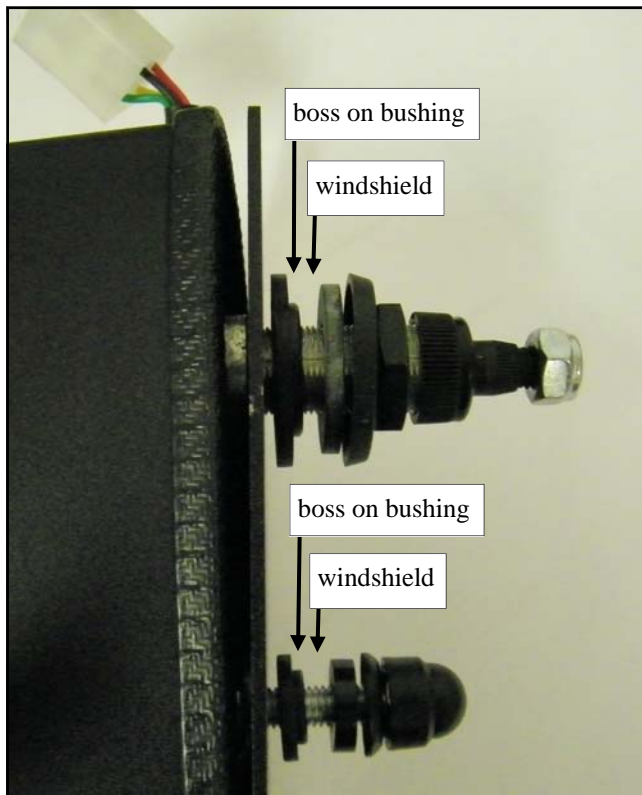

Fig. 1.1

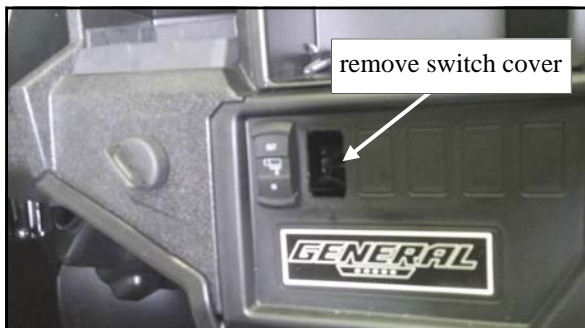

Fig. 1.2

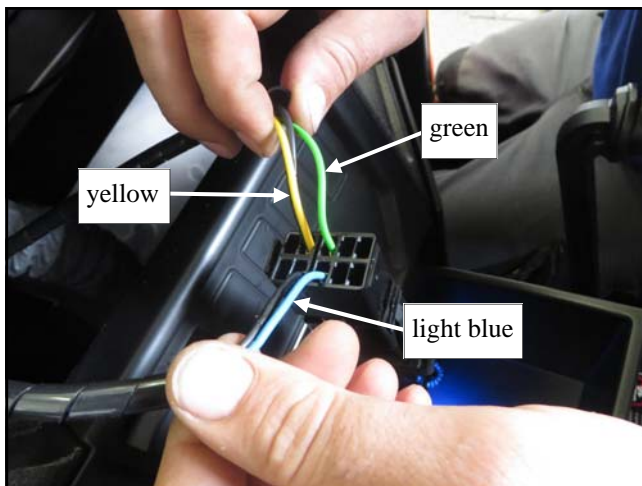

Fig. 1.3

## **1. WIPER INSTALLATION (cont'd.)**

1.4 Lead the wiper harness through the UTV roller cage to the wiper motor position.

1.5 Drill a 1/2" diameter hole (shown in the white circle in the photo) into the front upper plastic cover and lead the wiper harness to the center of the vehicle.

1.6 Complete the connection to the vehicle's battery.



Fig. 1.4



Fig. 1.5

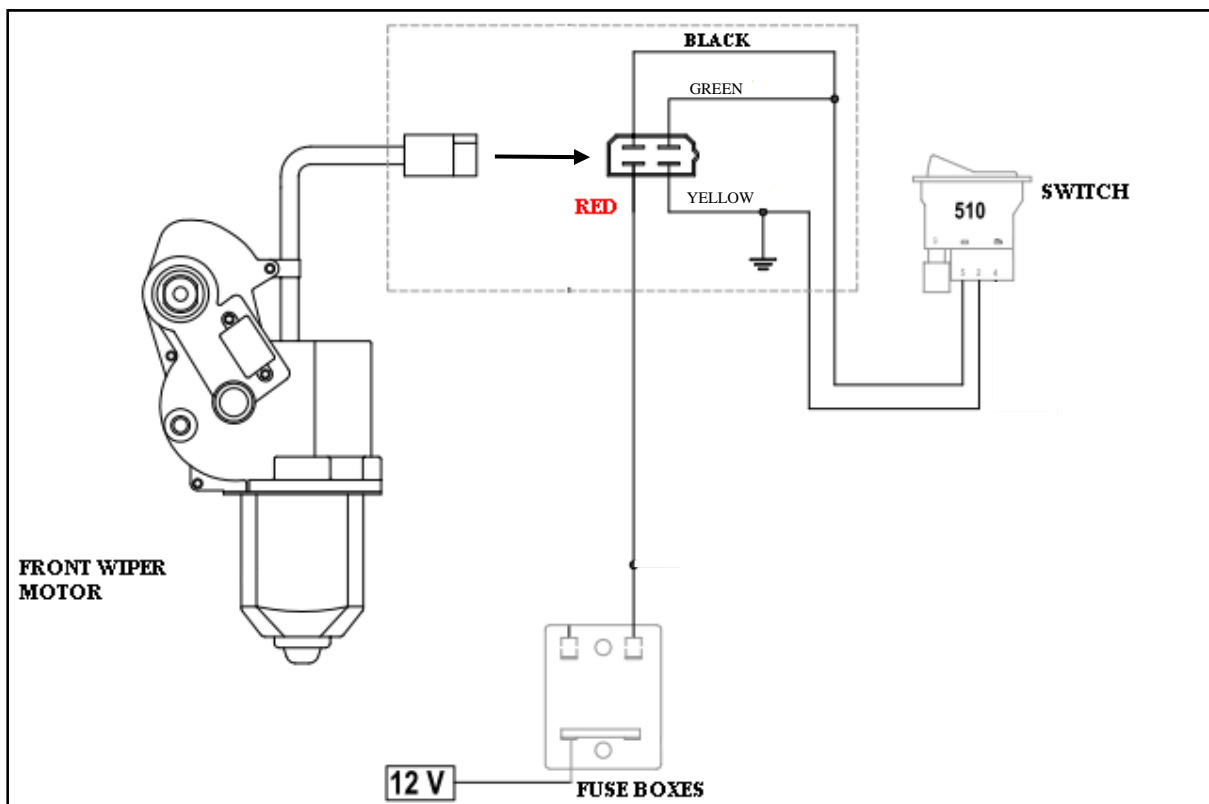

Fig. 1.7

## SERVICE PARTS

PART NUMBER:	DESCRIPTION:
9SV-00014	WIPER ARM (QTY.: ONE)
9SV-00021	WIPER BLADE (QTY.: ONE)
9SV-00097	SWITCH FOR WIPER (QTY.: ONE)